



Leadership Team:

Barry Doherty (Headteacher)
Natalie Hancock (DSL)
Alan Trainer
Daniel Gent
Yvette Armistead

Friday 15 November 2024

Dear Parents and Carers

In a slight diversion away from the normal news and updates, I wish to focus solely on our wonderful PTA and our ambitions for site development at CNS. As you will see, the PTA and our site dreams are VERY closely connected.

Site Development at Chipping Norton School

I hope that you are aware that although we have invested a great deal of time and energy focussing on raising standards of achievement amongst all our students, we have not neglected to modernise and transform our site as well.

In recent years, and with the support of the River Learning Trust, we have been able to provide a new and refurbished sixth form centre that is as good as any other school in the county. Meanwhile, we have created a brand-new key stage 4 dining hall that surpassed our students' expectations, and then transformed our main hall so that it became the new key stage 3 dining area, as well as the perfect location for our celebration assemblies, concerts and shows. Less noticeable overhauls, but no less important, have seen our IT systems, network and devices replaced and they are now fit for the 2020s. Your children will also have noticed the roll-out of large LCD screens in almost all classrooms so that the audio-visual experience in lessons is as it should be.

It is no coincidence that students' reported feelings of happiness and safety are in part down to the growing availability of different kinds of spaces they can now access at break and lunchtime. In the past, our students had few places to go and it could often feel a bit of a squash and a squeeze, especially on cold and wet days in November! For us, great spaces create a great atmosphere in school so that students can choose places that suit their needs and wants – some like things very quiet and others need to scream and shout and let off lots of steam!

The Next Phase

Going forward, we have identified two major developments that demand our attention. I wish to describe both to you today and suggest how you might support the school in securing these spaces for your children.

Stage One: A Community Kitchen

Design & Technology as a subject grows in popularity each year and is currently enjoying its best results ever. Food Technology, Health & Nutrition courses are also very popular, but also having an opportunity to cook and bake is becoming something that more and more students seek at CNS. Sadly, we only have one space to do this and the pressure grows each year to introduce a new cooking space to satisfy demand.

We have identified 'K1' for this purpose. It is at the far end of the Art & Design corridor and right now is a space that is available for a major transformation. It is our hope to create a community kitchen that can be utilised for multiple purposes:

- A classroom for all students in all year groups;
- An intervention space to work with students who need a less academic curriculum and benefit from practical activities to support their social and emotional growth. We have been inspired by our friends at *Branch Out & Cook* in this endeavour!
- A space to run clubs at lunchtime and after school;
- A place that the community might book and use for its own ends.



Designs and costings have been established to transform this space. Funding for this has to come from multiple sources to make it happen and we are delighted to share the news that the PTA wish to help us raise the funds to get this project over the line in the next twelve months – but we shall all need your help.

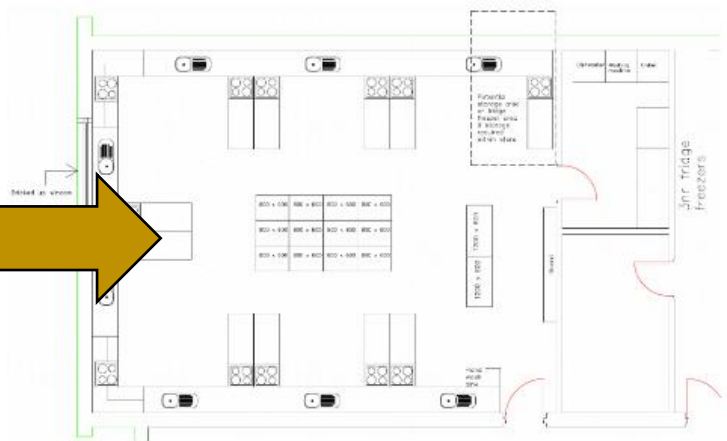

Stage Two: An Outdoor Covered Area

Going back to my opening comments, we know that if we can continue to develop spaces that our students love and value, then they will continue to feel safer and happier at school. Whilst we would love to use the fields all year round, the reality is that we cannot access them for many months each year, and this places pressure on everyone to remain indoors.

But what if we were to have a very large covered area that could be used all year round? We envisage another massive space that would have multiple purposes:

- An all-weather location for students to go and be outside with friends, either socialising or playing sports like basketball and rounders.
- An outside space to hold assemblies; performances, concerts and meetings. Safe from rainfall and summer UV levels!
- An additional sports zone to ensure PE lessons were never interrupted by poor weather.

We are at the very early stages of working on this plan but the PTA has again agreed to support the school over the next twelve to thirty-six months, to help turn the idea into a reality for our students. We were inspired by the area created at Chipping Campden School (image opposite) and how they described the enormously positive impact for students once the space became available.



Finding the Money

Unless we stumble upon a particularly generous benefactor, we have to search for several sources to generate the funds to turn these ambitions into physical spaces. The school can contribute some from its reserves and we can (and do) apply for funds that are allocated for similar purposes to the River Learning Trust. We can (and do) apply to other charities and trusts, and between them all get closer and closer to the figures needed to commence a relatively major project.

The Chipping Norton School PTA

You will be aware of the PTA at CNS and know how they have worked tirelessly over many years to add many extras to your children's education and lives. I am pleased to share that the PTA has discussed these plans and wish to throw their full support behind their delivery; starting with the community kitchen and then moving on to the outdoor area.

If you wish to learn more about the work of the PTA, then [please take a look at our PTA webpage](#) and also get in touch with the Joint Chairs; Alison Driver and Teresa Casey-Palmer. Both can be reached via office@chippingnortonschool.org.

Attached is a flier that the PTA has created and I ask that you look over it very carefully. In particular, the reference to the first way in which **YOU** and **YOUR FAMILY** can support these projects through the Christmas raffle tickets. Whilst we will happily accept donations, the raffle tickets give you an opportunity to win a wide range of gifts, including up to £450 of cash prizes. Our local community is right behind us and is already helping us in this endeavour with donations. Raffle tickets will be coming home with your children soon. ***Please help us help our children.***

Also, would you consider making a one-off or regular donation in the knowledge that every penny is invested in improving facilities for your children? Would you consider donating £5 per month or £5 per term? This is so easy to set up (having done so myself) and all you need to do is follow this link to [the PTA webpage](#), or the [donation link](#) itself.

I hope you have found this letter exciting and informative and that you feel able and motivated to consider additional ways to support the school and to help us strive to make CNS a better school every day.

Yours faithfully



Barry Doherty
Headteacher



ENRICHING OUR CHILDREN'S SCHOOL LIFE

PTA Fundraising - Winter 2024 - Ways to Help!

Xmas Raffle

The school community always gives generously to our raffle but this year we are trying to go Bigger and Better!

There are up to **£450** worth of **CASH prizes** to be won, and all proceeds go direct to school and our Big Fundraiser.

There will be 2 books of raffle tickets coming home per family – please look out for them and return stubs and cash to school.

Keep an eye out for us selling in the Co-op as usual and please give generously!
Have you asked all your extended family, and your work colleagues?
More books of Raffle tickets are available from the finance office- just ask for extras!

Regular Donation

DID YOU KNOW you can support us with a **one-off or regular monthly donation?** Some families are already doing this...and **If everyone who can, gives a little, it soon adds up to a lot.** The PTA can benefit further from these donations by claiming the gift aid on money raised so it really is worth it.

If just **HALF** of the parents donated **£5 per term** (the price of a pint!) we would raise **most of what is needed** for one of the big ideas.

If **HALF** of the parents donated **£5 per month**, we would have enough to significantly donate to **both** projects.

Setting this up is quick and easy on the school website home page. Just go to the **PTA** tab on the top of the menu to start.



ENRICHING OUR CHILDREN'S SCHOOL LIFE

COURAGEOUS & **COMPASSIONATE** HEARTS



CREATIVE

&

CURIOUS

MINDS